

Inserting System **autoSET 18 / autoSET XT**

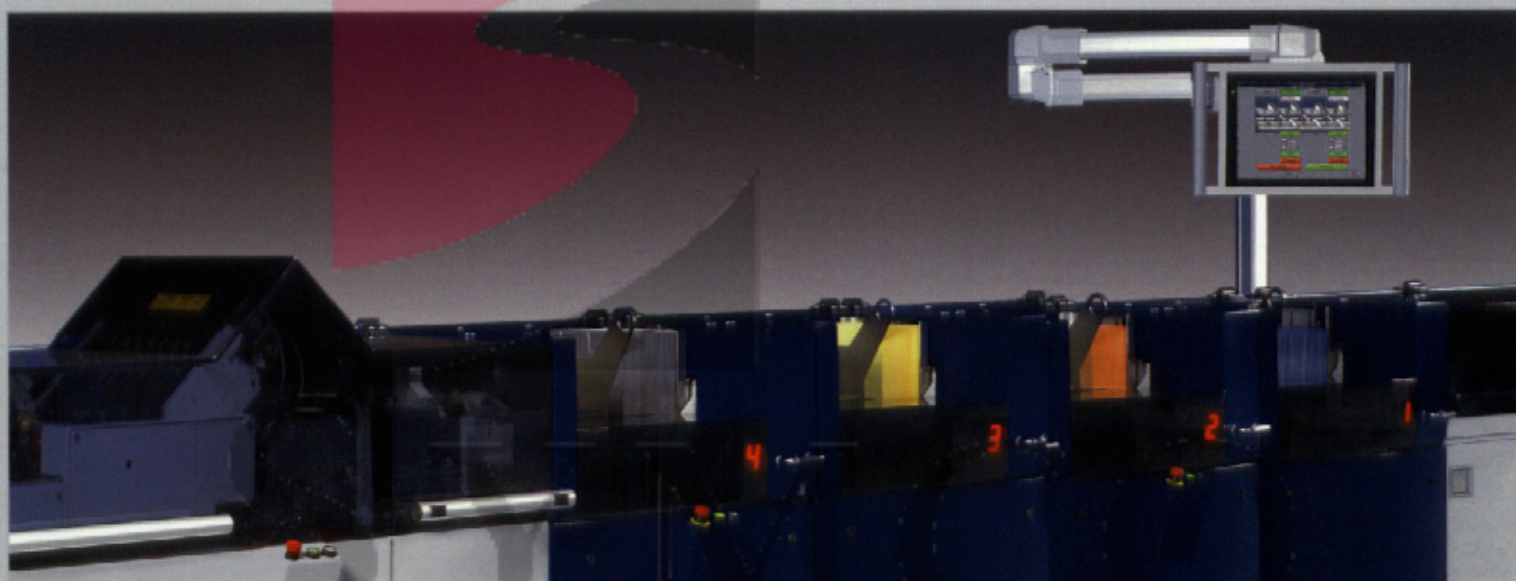

High-performance inserting system: Automated processes / Optimized ergonomics / Modern industrial design

GROUP

Inserting System autoSET 18 / autoSET XT



Modular document track

The document track is of modular design. Each module is equipped with two insert feeders. The system can be extended from 2 to 12 feeders or even a larger number upon customer request. Because of the modular design, an extension at a later date is possible on site.

Job changes normally involve many manual settings, such as format, material thickness and setting of the transport unit.

With autoSET 18 / autoSET XT, one tap on the touch-screen calls up a job from the memory and the job is set automatically. Each station may be addressed separately for format setting if desired. Sensors for double and missing sheet control, for monitoring material levels and paper flow in each station help guarantee trouble-free system operation.

Selective insert feeding and tandem operation is available for all feed stations.

Perfection with a system

Accurate operation is of utmost importance for personalized inserting. For this reason, the autoSET 18 / autoSET XT is equipped with an intelligent collation monitoring system. Control and monitoring devices track each document over its entire path. The system always knows where each document is and which insert from which station has to be added to an individual collation. Incorrect sets are guided into a diverter and the envelope is not closed.

By using several diverters, diversion according to predetermined criteria is possible.

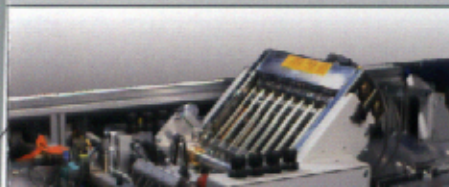

Feeding system 434 with four automatic fold plates



Feeding system 434/428 with transfer module

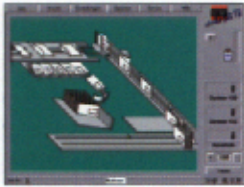

Touch-screen convenience

A central touch-screen control panel is the interactive operator interface of the autoSET 18 / autoSET XT.

Most settings are made from this point. Easy-to-understand pictograms for operator guidance facilitate the job.

Simply touching the symbols on the screen will change settings or reconfigure the entire system. Faults occurring during the work cycle are

visualized by means of icons or in plain language. The operator is alerted well in advance when the number of envelopes or inserts falls below a minimum quantity.

Operating and production data as well as diagnostics can be called up anytime. Set-up instructions for repetitive jobs can be saved and recalled.

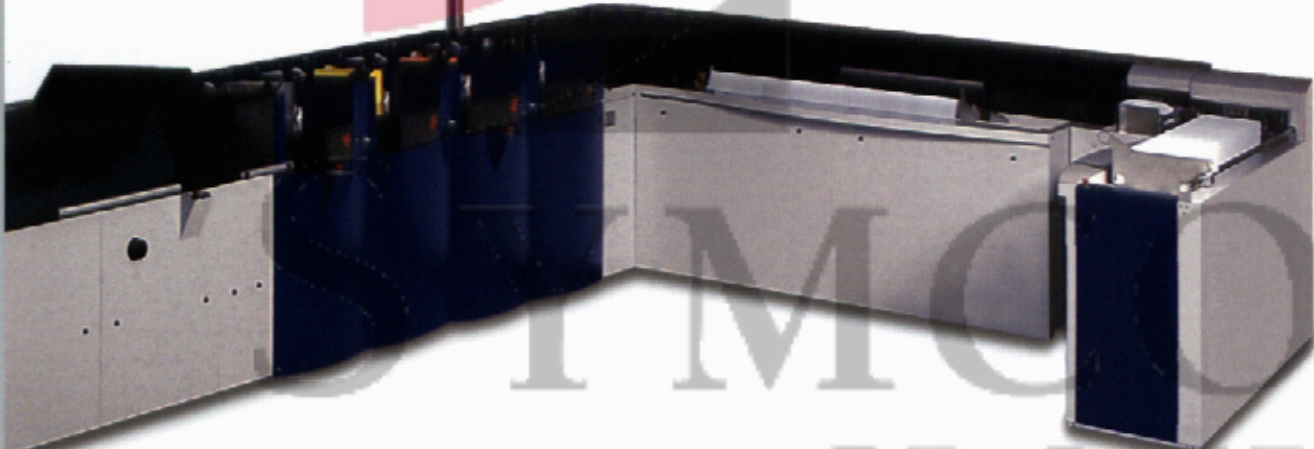

Modules:

- High-speed system 434
- High-speed system 434/428
- Document track with insert stations
- Insert module with envelope loader, enveloping station, sealing unit and diverter
- Collector (optional)
- Lay-down station (optional)
- Inkjet unit (optional)
- Cut sheet pre-loader (optional)
- Unwinder (optional)
- Merger (optional)
- Cutter (optional)

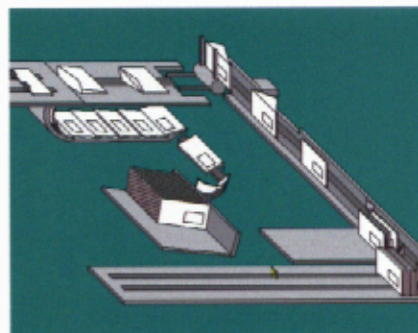

Automated enveloping module

Envelope size changes are totally automated. The operator enters the

depth. The control unit calculates the positions for the envelope feeder and the enveloping and sealing stations which are then set up automatically. The separation principle used allows processing even thin and difficult materials.

Control devices monitor all work cycles. Improperly loaded or not completely opened envelopes are recognized and diverted without disrupting system operation.

Vision module

The vision module is used for production control. Envelopes that are ready for dispatch are read in the delivery section. Envelopes that cannot be clearly identified are directed into a second diverter without interruption of the machine run.

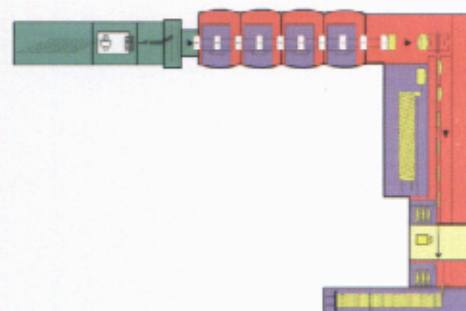

On-edge stacker

In the on-edge stacker, the envelopes are delivered vertically and take up less space. This extends the capacity, intervals between removals are increased accordingly.

As this delivery principle continuously forms a precise stack, the envelopes are always in a position where they can be removed with ease and there is no need to jog them.

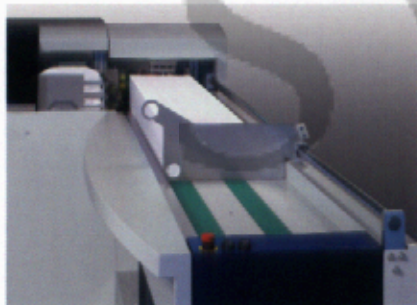
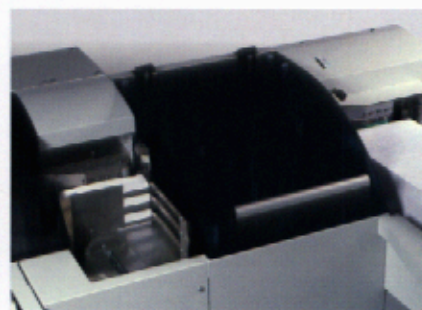
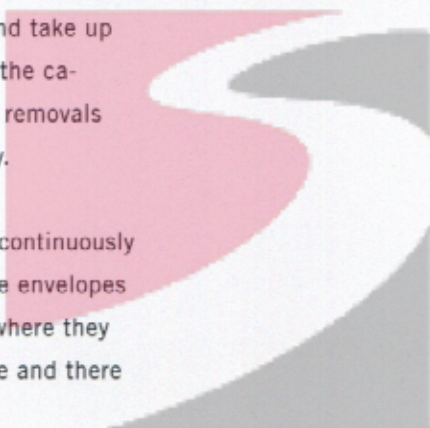

Inkjet module

The inkjet module is used when additional information has to be added to the envelopes.

Examples:

- Imprinting addresses on windowless envelopes
- Imprinting date and time of day
- Imprinting information or advertising slogans

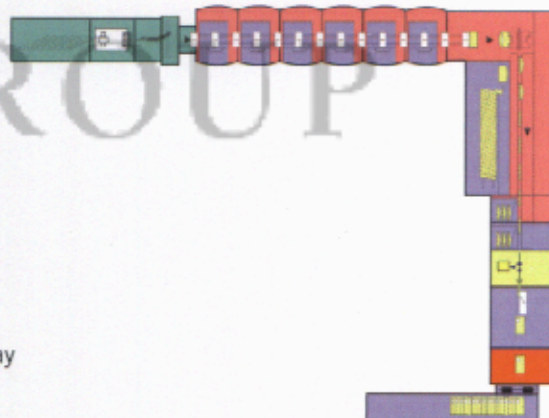

An optional kicker device identifies zip code breaks facilitating further the off-loading and sortation of the envelopes into postal trays.

And there is another advantage: manual change-over when selecting another format is a thing of the past.

Envelope loader for 3,000 envelopes

Diverter for incorrect envelopes

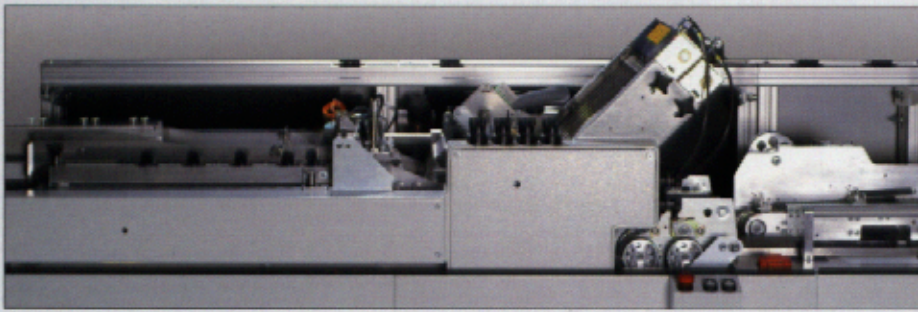

High-capacity feeding systems

Efficiency and flexibility of feeding systems are major criteria for the productivity. Of particular importance is the capability of feeding various types and sizes of materials, easy set-up of the fold unit, the maximum number of

sheets per set, the accumulating speed, overall processing throughput and feeding documents with single or double systems.

For autoSET 18 / autoSET XT there is a choice between feeding systems 434 and 434/428:

MB-System 434

- Universal high-speed feeding system for collecting and folding
- With input from:
 - Cutter (continuous forms)
 - Cut sheet pre-loader
- Processing of continuous forms and cut sheet possible in one system
- High-speed accumulator working on a patented principle
- Optical code reading systems with options for component matching to ensure document accuracy and a very high level of security
- Automatic fold unit, suitable for large numbers of sheets per set
- Buffer stations

MB-System 434/428

- Universal high-speed feeding system
 - collecting and folding
 - collecting 4"-documents
- With input from:
 - Cutter (continuous forms)
 - Cut sheet pre-loader
 - On-line-system 915 for slitting cut sheet A4 / 8.5" x 11" into 3 documents
- Processing of continuous forms and cut sheet possible in one system
- High-speed accumulator working on a patented principle
- High accumulating capacity (1 to 26 sheets 4"; 80 GSM)
- Optical code reading systems with options for component matching to ensure document accuracy and a very high level of security
- Automatic fold unit, suitable for large numbers of sheets per set
- Buffer stations

High-capacity universal feeders

Thick or thin inserts, glossy or matte surfaces, single or multi pages, open or closed edges, cards or brochures are no problem for the standard suction feeder, because products are separated pneumatically.

It does not matter whether the feeder magazine is loaded to capacity or is down to a few sheets, there is always reliable sheet separation. This is made possible by a new design that guarantees consistent pressure at the feed point regardless of the weight of product in the hopper.

Loading is done from the operator's side at an ergonomically optimal height.

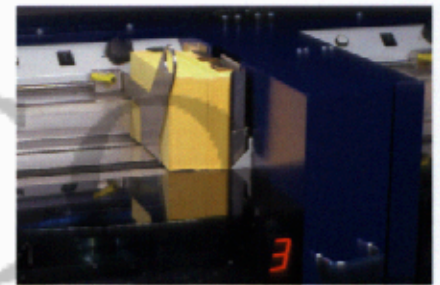

Friction and rotary drum feeders are available for special requirements.



Simple operation by means of a touch-screen panel



Insert station with friction and suction feeder

Inserting System autoSET 18 / autoSET XT

A class of its own in mail handling.
Clearly more value at substantially less cost.

autoSET 18 / autoSET XT is an inserting system that stays in step with growing demands. Its main characteristics are high productivity, processing security, gentle material transport, modular design, efficient ergonomics of the workplace, flexible high-capacity feeding systems and an intelligent machine control system. A linear flow of documents without change of direction from the feeding system to the enveloping station is optimal for trouble-free operation of the system at high throughput.

Maximum operator convenience through motorized settings from the feeding system to the delivery:

Automatic format setting controls the following system modules:

- Feeding system
- Accumulator
- 4 fold-plate fold unit
- Collector
- Document track
- Insert stations
- Envelope loader
- Enveloping station
- Sealing station
- Diverter
- On-edge stacker



Users

Banks, insurance companies, service providers, telecommunications companies and public utilities as well as governmental agencies with high mail

It's the benefits that count

- Simple operation
- Minimum set-up times
- Operator-friendly system layout
- Good accessibility
- High degree of modularity
- Reduced personnel requirement

The facts:

More convenience

More operational availability

More profitability

Software System Solutions

The autoSET inserting systems meet the increased requirements with regard to safety, reporting and integrity.

The customized software solutions provide appropriate solution components for this purpose:

- Monitoring
- Jobticket
- Database check
- Mailpiece control
- File-based processing

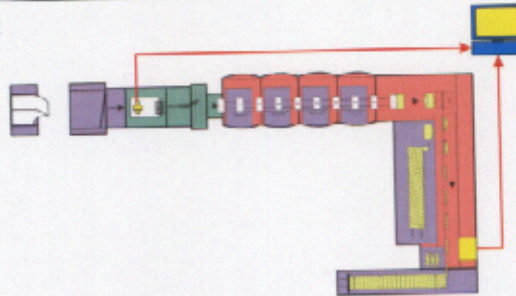

Innovations that increase productivity

- Touch-screen technology simplifies operation
- Automatic setting reduces set-up times considerably
- Servo technology permits smooth stops
- High loading capacity of the feeders allows uninterrupted and secure machine operation with minimum operator involvement
- High-speed feeding systems with unique patented accumulation and fold modules create the basis for high document throughput



Collector for collecting after folding



Easily accessible document track because of swing-mounted insert

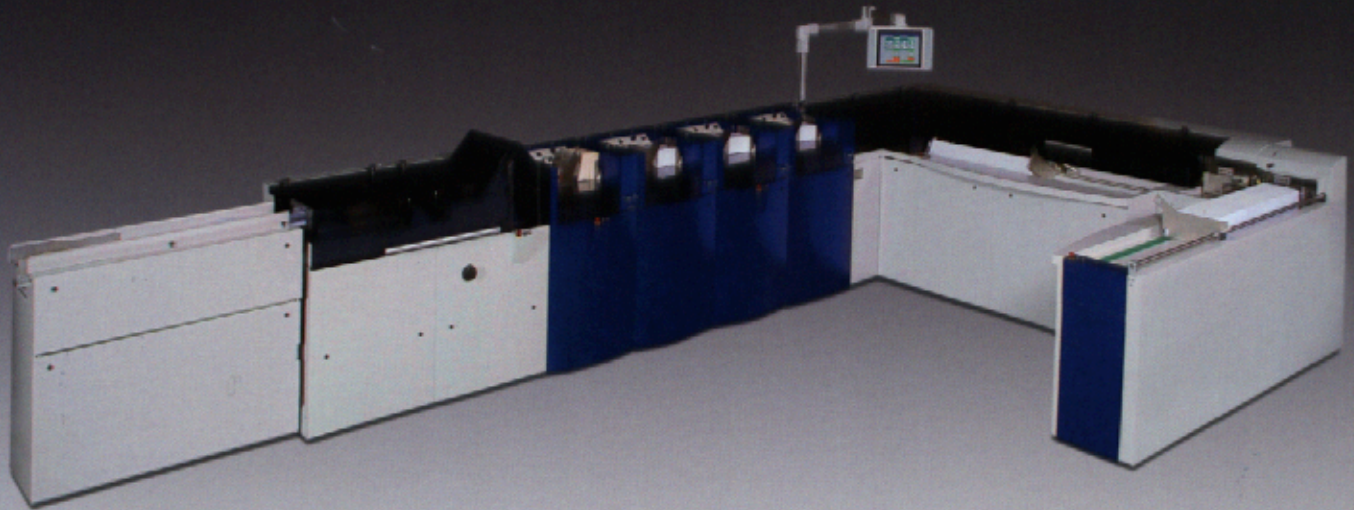

autoSET 18 with cut sheet pre-loader

Optional equipment

- Loading modules for feeding systems
- Collector after folding
- Inkjet addressing
- Integrity control
- Postage meter modules
- Kicker for on-edge stacker
- Conveyor
- Ink marker
- Matching
- Monitoring
- File-based processing

Inserting System autoSET 18 / autoSET XT

Specifications:

Speed: max. 18,000 cycles/h – autoSET 18
max. 23,000 cycles/h – autoSET XT

Envelopes

Sizes: min. height x width: 105 x 170 mm (4.13" x 6.69")
max. height x width: 170 x 250 mm (6.69" x 9.84")

Envelope weight: 70 to 120 GSM (18-32 lb. bond)

Loader capacity: 3,000 envelopes (80 GSM) (20 lb. bond)

Inserts

Sizes: min. height x width: 60 x 105 mm (2.36" x 4.13")
max. height x width: 165 x 228 mm (6.49" x 8.97")

Paper weight: 60 to 200 GSM (16-53 lb.)

Loading capacity: 4,000 sheets (80 GSM (20 lb. bond) unfolded)

Thickness: max. 3 mm (0.12")

On-edge stacker

Capacity: Belt length 170 cm (67"), approx. 2,000 envelopes (depending on contents)

Electrical

Voltage: 208 - 400 VAC 3-Phase

Frequency: 50/60 Hz

Technical improvements may be introduced without previous notice.

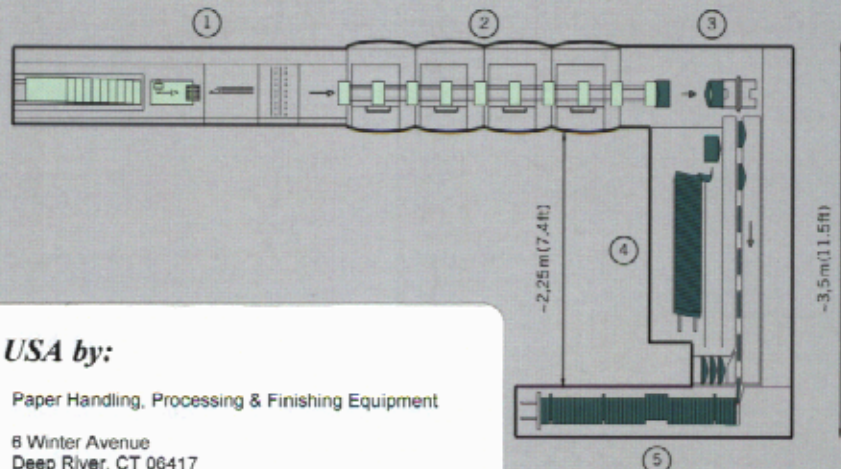

Distributed in the USA by:



Paper Handling, Processing & Finishing Equipment

6 Winter Avenue
Deep River, CT 06417
Phone: 800-833-8167

Fax: 860-528-2747