

multimaster **CAS 38-A** / multimaster **CAS 52-B**

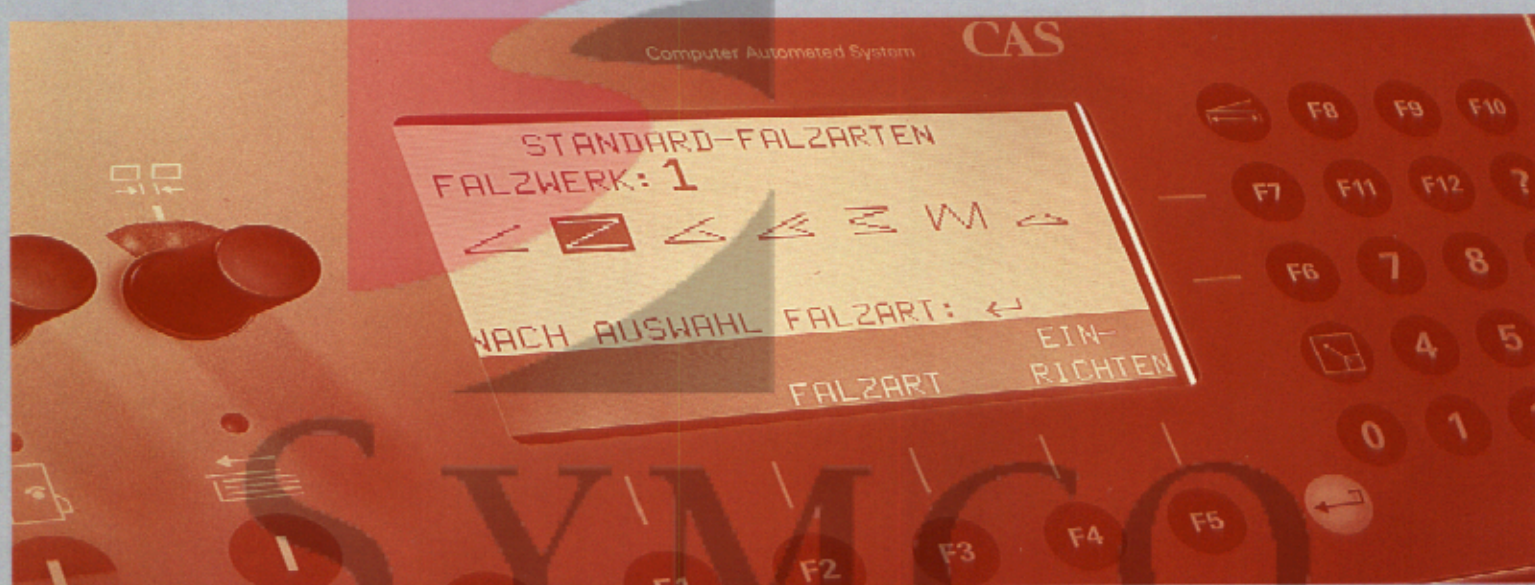

Folding Better Automatically: Shorter Set-up Times / Easier Operation / Higher Productivity

GROUP

MB
MATHIAS BÄUERLE



multimaster CAS 52-B/4/4

First and second fold unit with 4 automatic fold plates each.

SIMCO
GROUP



multimaster CAS 52-B/4/4/MS 45

Other Opt

Polyurethane/
Turnover fold
tools • Pressi

SetMATIC: More operator convenience through even fewer setting elements

- No screws to turn for fold roller setting
- No handwheels to crank for positioning the alignment rails
- Nothing to set in the delivery area
- No switch to turn for setting speed, sheet gap and fanned delivery

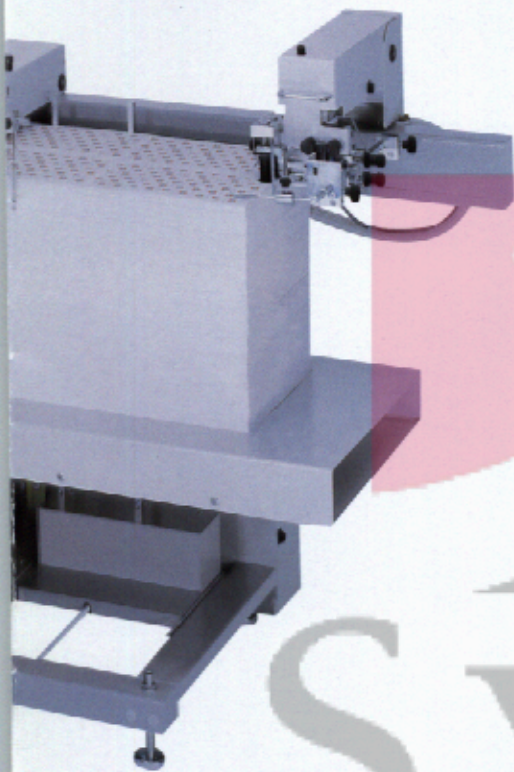

**Top-loading,
bottom-feed air feeder PBA
with preloading device**
(for multimaster CAS 38 only)

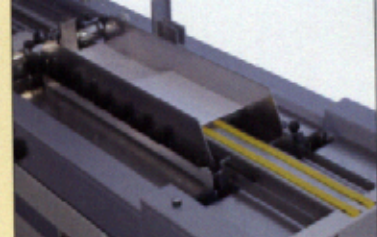

Code reading device

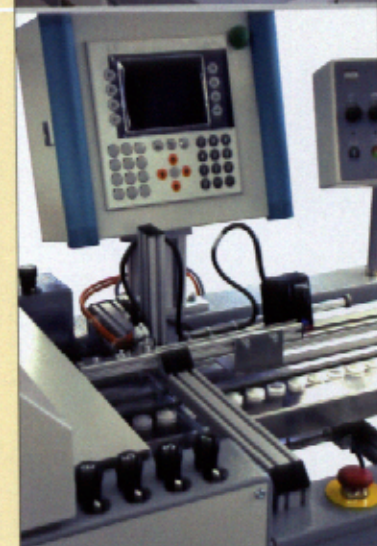

**Module for timed gluing and
perforating
with tiltable support**



Timed perforation



**Deliveries to suit your
requirements**

Mobile delivery AM 52

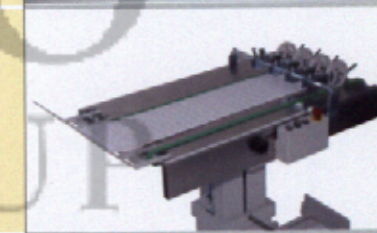

**Small format vertical stacker
SKM 36 (also with kicker)**

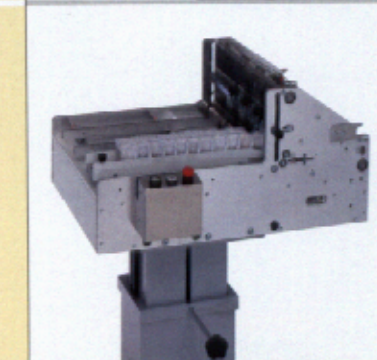

Additional Equipment:

- steel folder rollers
- Soft rollers
- Gate fold plate
- plate
- Slitting tools
- Perforating tools
- Scoring station
- Wrapping unit
- Labelling unit

Frequency-controlled setting • Fold program sensor • Double sheet counting • Total count



multimaster CAS 38-A/4 PBA



multimaster CAS 38-A/4 FSA



multimaster CAS 38-A/4 PBA

The first fold unit comes with 4 automatic fold plates, the second fold unit can be equipped with 2 or 4 plates.

drives • Automatic fold plates with motor-driven stop
n memory • Electronic paper travel control • Paper thickness
detection • Sheet gap control • Feeder control • Batch
ing • Display of the actual throughput • Timed delivery

Custom-made solutions:

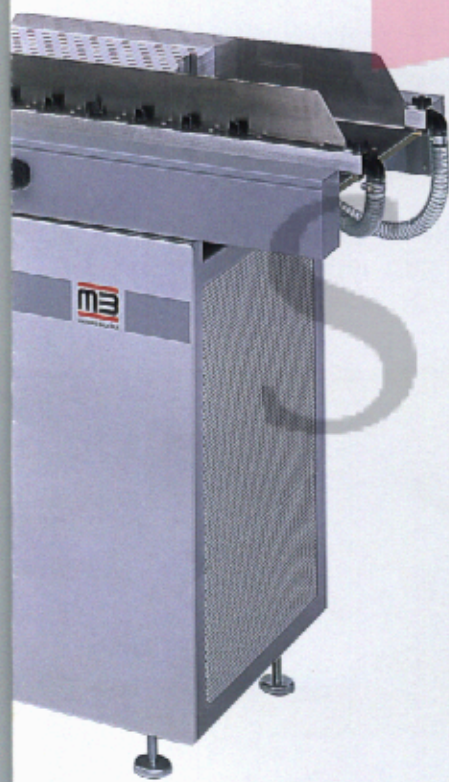

Two-up crossfold option

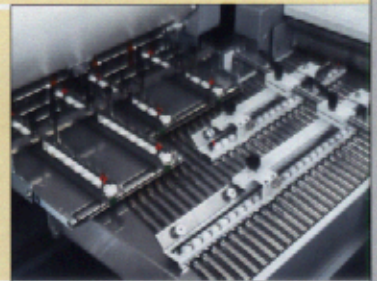

Mobile knife fold unit MS 45,
rotates by 180°. The infeed
height is continuously adjustable.

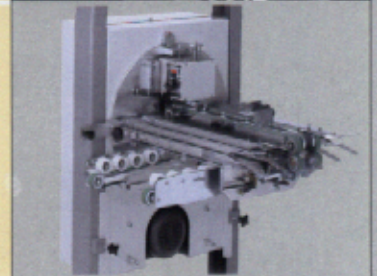

Additional fold unit KF 31
with two fold plates. Increases
the fold variability and makes
small folds possible.



Gluing device

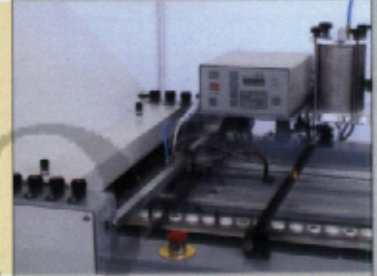

Antistatic device

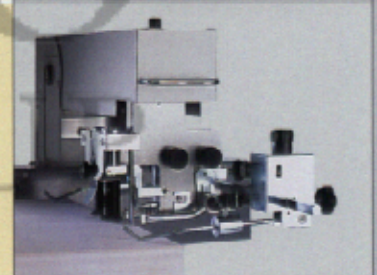

Flat pile feeder FSA
with automatic stack mechanism
and rear edge separator.

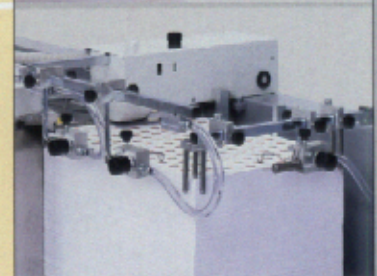

Flat pile feeder FSA
with automatic stack mechanism
and side blowers.



**Top-loading,
bottom-feed air feeder PBA**
(for multimaster CAS 38 only)

SYMCO GROUP

Higher Efficiency through Computer Control



A number of years ago multimaster CAS paved the way to computer-controlled folding. Before that it had not been possible to use a folder so effectively. And now - with its further refined systems - it is again a generation ahead of its competitors.

multimaster CAS is fast, simple, intelligent and variable. All standard folds are programmed, other folds are freely programmable. The system memorizes 60 individual fold jobs, which is especially useful for repetitive work.

With the dialog display, you always have a clear picture. Malfunctions are displayed in the language of your choice. You can also switch from metric to inches or vice versa.

multimaster CAS is available in two versions.



multimaster CAS 38-A: Proven control combined with super intelligence

By simply pushing a button, you leave the most important settings to CAS, the machine's digital control system. CAS is the autopilot that takes care of a number of routine jobs for you:

- No measuring of fold lengths.
- No calculating of stop positions.
- No need to remove fold plates and insert deflectors.
- No special know-how about the correct fold roller pressures.

Thus a number of factors cut costs:

- Set-up times are reduced by more than 50 %.
- Quick change of jobs.
- No qualified personnel required.
- Less waste.

Fold length setting. After entering the type of fold, the stops move to the calculated position and the deflector is engaged automatically.



Automation of fold length setting



After a button has been pushed, timing belts and servo motors precisely position the fold plate stops according to the computer data. Deflectors are engaged automatically. Fine adjustment

Heavy duty machine frame



Cast side plates account for rock-solid performance. Maintenance-free flat drive belts on both sides provide quiet operation and high folding accuracy.

Shorter Set-up Times

Easier Operation

Higher Productivity

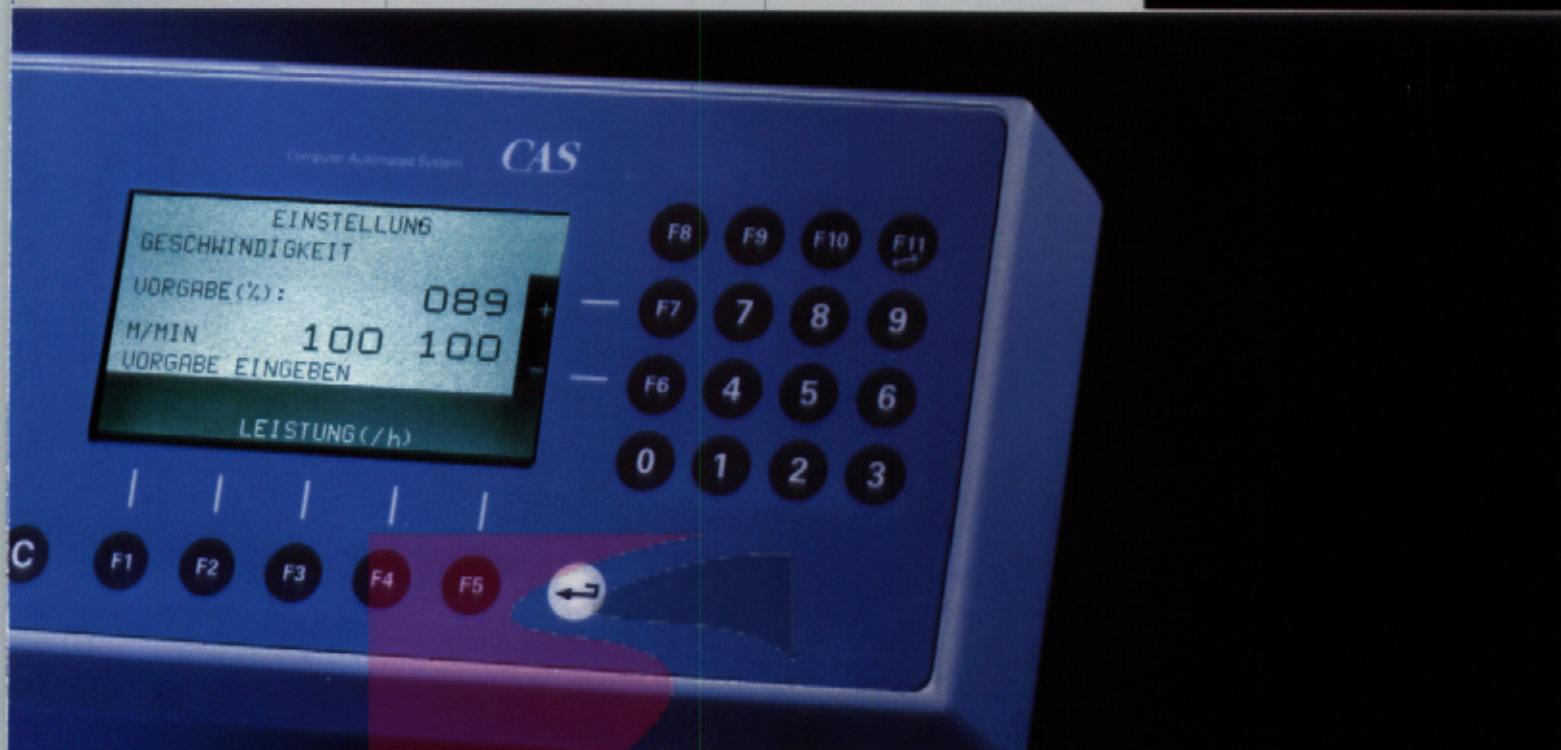

multimaster CAS 52-B: Increased benefit through SetMATIC

No computer control of any folder is based on so much experience as the CAS. But there is still room for refinement. SetMATIC is the formula for even more convenience and higher efficiency. The machines of the multimaster CAS - Version B range are all equipped with SetMATIC. The already short set-up times are even further reduced and operation is facilitated.

SetMATIC takes over the following functions:

- Automatic setting of fold rollers
- Automatic setting of alignment rails
- Automatic positioning of delivery rollers
- Automatic setting of data for jobs saved previously

Fold roller setting. From the measured paper thickness and type of fold the roller gap is calculated and set. Asymmetrical settings are also possible.

Alignment rail setting. Alignment rails are set automatically.

Delivery roller setting. Depending on the final size, the delivery rollers move to their correct positions.

Automatic setting of data for jobs saved previously. Speed, sheet gap, fanned delivery, suction length, counting functions and sheet controls are also set.

HALZENABSTAND (mm)	
FALZWERK: 2	ABSTAND: 1/1
IST: 1.18	
KORREKTUR MIT -/+	
AUSWAHL	
FALZWERK	SEITE ZURÜCK

POSITION (mm)	
AUSRICHTSCHENE	FALZWERK 1
IST: 210	SOLL: 115
NACH ZAHLENEINGABE: ←	
AUSWAHL	
	EIN- + RICHTEN

POSITION (mm)	
ROLLEN AUSLAGE	
IST: 254	SOLL: 210
NACH ZAHLENEINGABE: ←	
AUSWAHL	
	EIN- + RICHTEN

AUFTRAG SPEICHERN	
ANZAHL BEREITS GESPEICHERTER AUFTRÄGE: 04	MAXIMAL: 60
AUFTRAGSNUMMER: 1564	
NACH ZAHLENEINGABE: ←	

Choice of fold rollers



Polyurethane/steel combination rollers or soft rollers for any possible folding job.

Automatic setting



Fold plates with built-in deflectors. Uninterrupted deflector surfaces eliminate marks and streaks on any paper.

multimaster CAS 38

Paper sizes: PBA 38 max. 38 x 65 cm (14 15/16" x 25 9/16") min. 7 x 12 cm (2 3/4" x 4 11/16")
 FSA 38 max. 38 x 65 cm (14 15/16" x 25 9/16") min. 10 x 12 cm (3 15/16" x 4 11/16")

Fold length: min. 3.5 cm (1 3/8") with additional fold unit KF 31: min. 1.8 cm (11/16")

Paper weight: 40 to 250 GSM (13 lb. bond to 90 lb. cover) for single parallel fold

Speed: 200 m/min. (656.2 ft./min.)

Electrical: Voltage 3 x 400 V / 50 Hz / N / PE or 3 x 208 V / 60 Hz / PE
 Current consumption max. 10 A

Power consumption:

First fold unit with feeder	0.9 kW (900 W)	Delivery	0.1 kW (100 W)
Second fold unit with roller table	0.9 kW (900 W)	Blower	2 x 1.1 kW (2 x 1,100 W)
Mobile knife fold unit MS 45	0.8 kW (800 W)	Pump	1.9 kW (1,900 W)

Weight (net): First fold unit with register table, feeder PBA 38 270 kg (595 lbs.)
 First fold unit with register table, feeder FSA 38 370 kg (816 lbs.)
 Second fold unit with roller table 230 kg (507 lbs.)
 Mobile knife fold unit MS 45 140 kg (309 lbs.)
 Additional fold unit KF 31 20 kg (44 lbs.)

Delivery AM 52 60 kg (132 lbs.)
 Small format vertical stacker SKM 36 60 kg (132 lbs.)
 Blower 2 x 17 kg (2 x 37 lbs.)
 Pump 40 kg (88 lbs.)

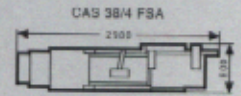

multimaster CAS 52

Paper sizes: Buckle fold unit max. 52 x 85 cm (20 7/16" x 33 7/16") min. 10 x 12 cm (3 15/16" x 4 11/16")
 Combined buckle/knife fold system (16-page crossfold) max. 52 x 72 cm (20 7/16" x 28 5/16") min. 15 x 30 cm (5 7/8" x 11 13/16")

Fold length: Buckle fold unit min. 3.5 cm (1 3/8")

Paper weight: 40 to 250 GSM (13 lb. bond to 90 lb. cover) for single parallel fold

Speed: 200 m/min. (656 ft./min.)

Electrical: Voltage 3 x 400 V / 50 Hz / N / PE or 3 x 208 V / 60 Hz / PE
 Current consumption max. 10 A

Power consumption:

First fold unit with feeder	0.9 kW (900 W)	Delivery	0.1 kW (100 W)
Second fold unit with roller table	0.9 kW (900 W)	Pump	1.9 kW (1,900 W)
Mobile knife fold unit MS 45	0.8 kW (800 W)		

Weight (net): First fold unit with register table, feeder FSA 52 415 kg (915 lbs.)
 Second fold unit with register table 240 kg (529 lbs.)

Mobile knife fold unit MS 45 140 kg (309 lbs.)
 Additional fold unit KF 31 20 kg (44 lbs.)

Delivery AM 52 60 kg (132 lbs.)
 Small format vertical stacker SKM 36 60 kg (132 lbs.)
 Pump 40 kg (88 lbs.)

CAS 52/4 FSA

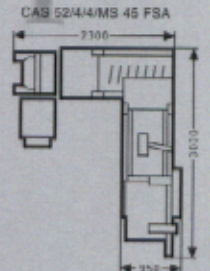
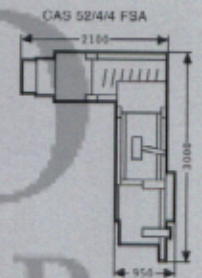
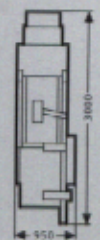

Technical improvements may be introduced without previous notice.

Folding Better Automatically



Distributed in the USA by:



Paper Handling, Processing & Finishing Equipment

6 Winter Avenue
 Deep River, CT 06417
 Phone: 800-833-6167
 E-Mail: salcs@gbr.com

Fax: 860-526-2747
 Website: <http://www.gbr.com>